

Counterframe system for a single pocket door. Ideal to save space and make more practical use of any room.

Finished wall thickness 100 or 125mm

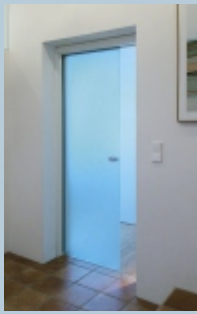

Glass door options also available please call for further details

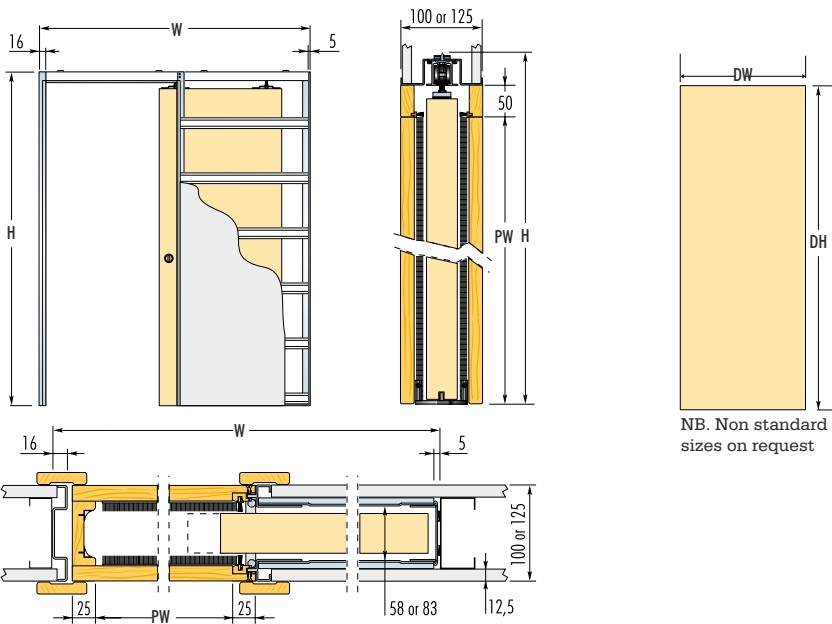

NB. Non standard sizes on request

AVAILABLE ACCESSORIES

- Soft Close
- Self Closing Mechanism
- Door Furniture

FURTHER INFORMATION

POCKETDOORSHOP.CO.UK
0113 245 9559
info@pocketdoors.co.uk



FRAMES FOR SINGLE DOORS

DOOR PANEL UK

NOTES

Max Passage Size PW x PH	Overall Dimension W x H	Finished Wall	Standard	
			DW	DH
600 x 2030	1288 x 2115	100 or 125	626	2040
700 x 2030	1488 x 2115	100 or 125	726	2040
800 x 2030	1688 x 2115	100 or 125	826	2040
900 x 2030	1888 x 2115	100 or 125	926	2040
1000 x 2030	2088 x 2115	100 or 125	1026	2040
585 x 1971	1273 x 2056	100 or 125	2ft. 0in. x 6ft. 6in. (610 x 1981mm)	
661 x 1971	1449 x 2056	100 or 125	2ft. 3in. x 6ft. 6in. (686 x 1981mm)	
737 x 1971	1625 x 2056	100 or 125	2ft. 6in. x 6ft. 6in. (762 x 1981mm)	
813 x 1971	1701 x 2056	100 or 125	2ft. 9in. x 6ft. 6in. (838 x 1981mm)	
900 x 1971	1888 x 2056	100 or 125	3ft. 0in. x 6ft. 6in. (914 x 1981mm)	

Suitable for use with 35-44mm thick doors
 Max door weight 80kg (120kg on request)

When fitting flush pull handles we recommend the stop be regulated so the door protrudes from the pocket to avoid risk to fingers.

Should the door be set to enter the pocket completely we do not accept any liability

Doors, plasterboard and final architrave are **NOT** supplied