

Essentials Bathroom Lock Instructions

Eclipse UK Rebate Dimensions for 4120 Lock

Leading Edge of the Door

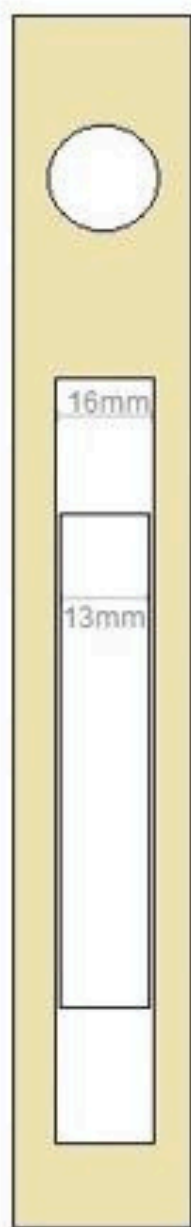

Side Profile of the Door

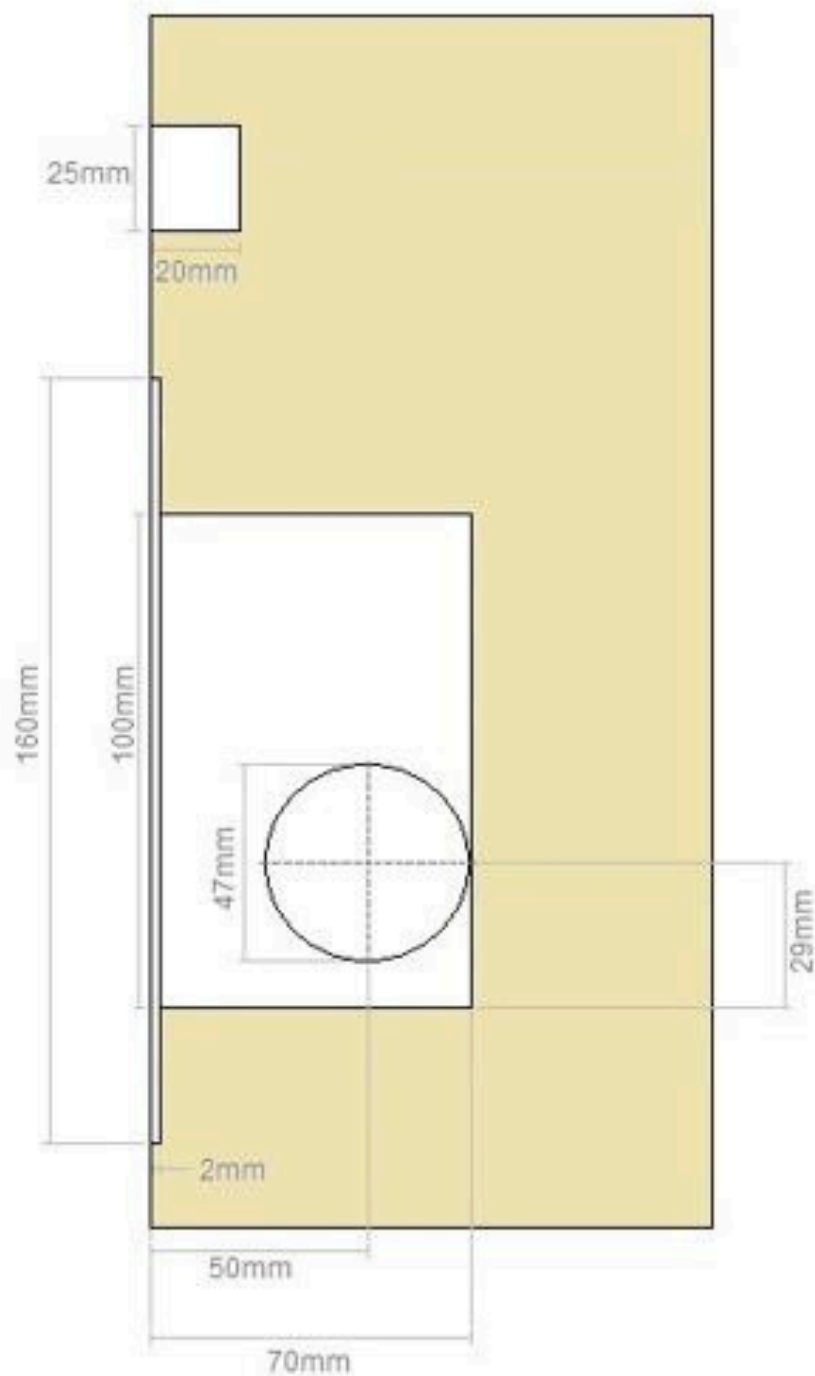

Strike Plate for Doorpost
(Screw onto face of doorpost - Do Not Rebate)

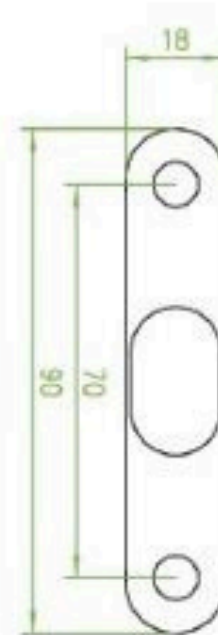

What's in the box?

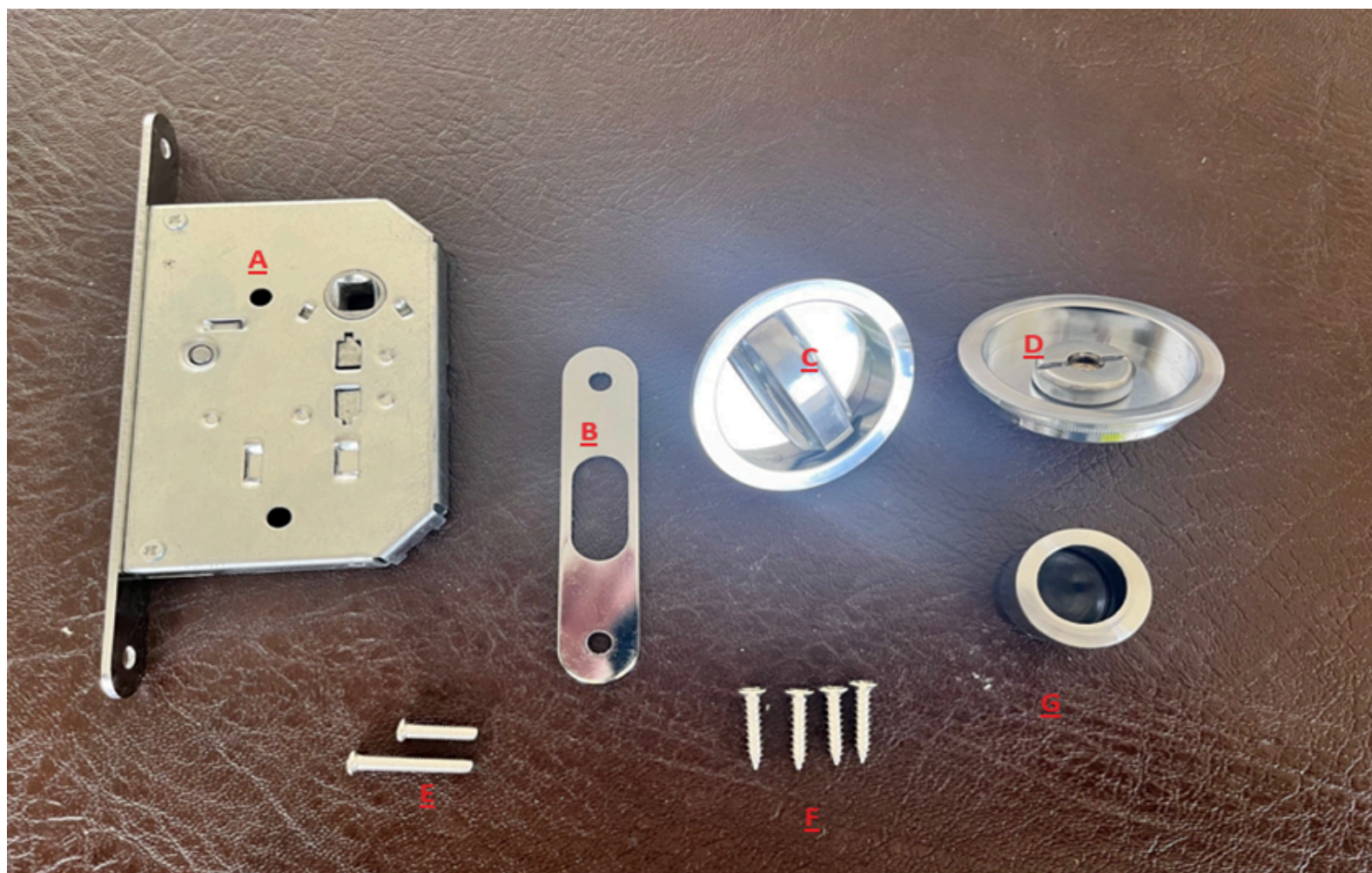

A - Main Lock Body

B - Strike Plate

C - Thumb Turn with Spindle (and connector bolt for 35mm thick door)

D - Emergency Release with Spindle Housing

E - Connection bolts for 35mm thick and 44mm thick doors (use as appropriate - please note that the connection bolt for a 35mm thick door is already attached to part C)

F - Screws to attach main lock body to door panel and strike plate to door post

G - Finger pull for the leading edge of the door panel

Connector bolt for 35mm thick door pre-installed into part C (Fig. 1) and detached (Fig.2)



Fig. 1



Fig. 2

The inner diameter for the Essentials lock is approximately 47mm (Fig. 3) and the external diameter is approximately 54mm (Fig. 4)



Fig. 3



Fig. 4

The spindle thickness is 8mm (Fig. 5):

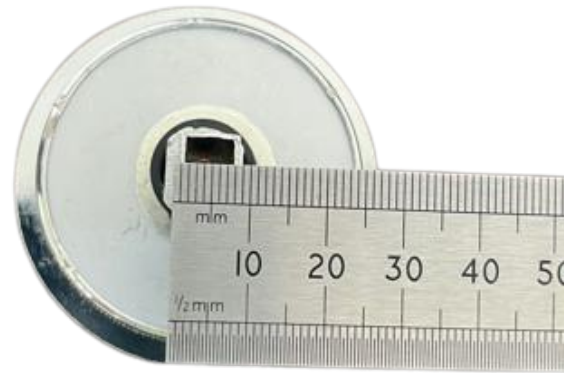

Fig. 5

The main lock body is approximately 160mm long including the fascia plate (Fig. 6) and approximately 100mm internally (Fig. 7):



Fig. 6



Fig. 7

The thickness of the lock body is approximately 16mm including the thickness of the fascia plate (Fig. 8) and approximately 13mm internally (Fig. 9):



Fig. 8



Fig. 9

Once, the main lock body is installed in your door panel, insert both the thumb turn with spindle (part C) and emergency release with spindle housing (part D) into it and connect both sides using either the connector bolt for the 35mm door (Fig. 10), or the connector bolt for the 44mm thick door (Fig. 11):



Fig. 10



Fig. 11

Once this is done, position the strike plate on the face of the door post (ensuring that it is located correctly in line and level with the main lock body)

and rebate the door post to accept the hook lock. Install the strike plate using the screws provided and test to ensure that the lock functions

correctly and all components are correctly located, reposition lock components or realign the door panel as necessary before finalising the

installation. If the installation is not correct, this may cause the lock to bind in place or jam in the locked position, so it is imperative that the lock is

correctly located and aligned to minimise any future issues which may be caused because of an incorrect installation.

The finger pull for the leading edge of the door can be installed as well, if necessary, depending on whether you are intending to recess the door fully into the pocket. Please note that Eclisse recommend that the door protrudes from the pocket to avoid risk to fingers. Should the door be adjusted to enter the pocket completely, we do not accept any liability.

Please be advised that the finger pull has a lip to allow for greater ease of use (Fig. 12):



Fig. 12